

# Anti-Theft Radio Installation Instructions

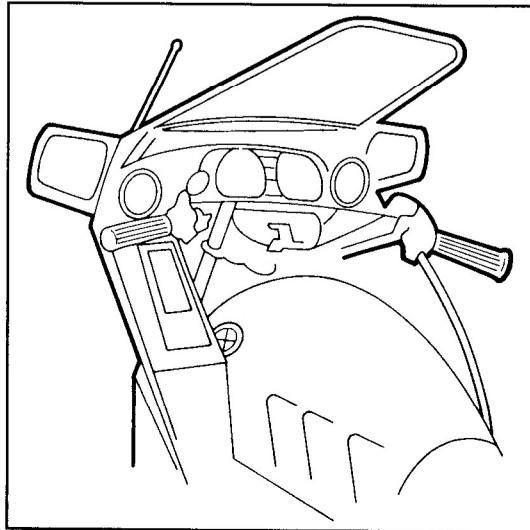

**(Part Number: 65 142 304 504)**

\* Note these instructions were prepared with the assumption that the loud speakers, antenna and power harness have been factory installed. If this is not the case then install a BMW radio installation kit before proceeding.

Record Vehicle I.D. number and chassis number (stamped into radio) onto the ELO Card Carrier. Place the ELO card and Owner's Manual into vehicle document kit and removal tools into the right-hand storage compartment.

## ■ REMOVING AND MOUNTING THE AUDIO MOUNTING BRACKET

<for model R100RT, K1100LT, K100RT/LT>

1. Remove the protection cover and snap out carrier frame from the left-hand storage compartment.
  2. Remove left-hand storage compartment by removing the six phillips screws that hold it in place. Carefully guide the wire harness through, out of the storage compartment.
- \* If model is equipped with surface plate only, discard the plate and replace it with the antivibration carrier frame and bracket assembly.

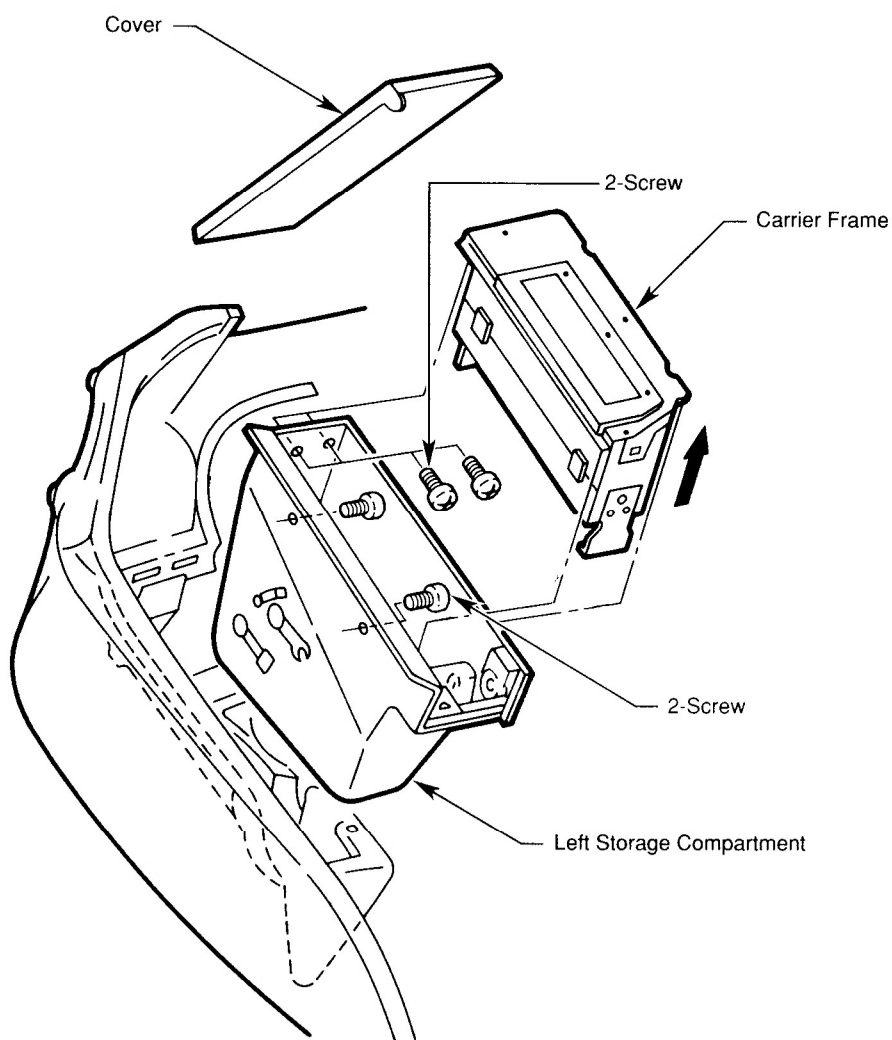

## ■ REMOVING AND MOUNTING THE AUDIO MOUNTING BRACKET

<for model R1100RT>

1. Remove the side part L, a hexagon nut, and seven hexagon head screws to remove the water-proof cover and the audio mounting bracket.
2. After removal, wire as shown in the instructions on page 8 of this manual.
3. Mount the audio mounting bracket, water-proof cover, and side part L in the reverse order of the removal procedure.

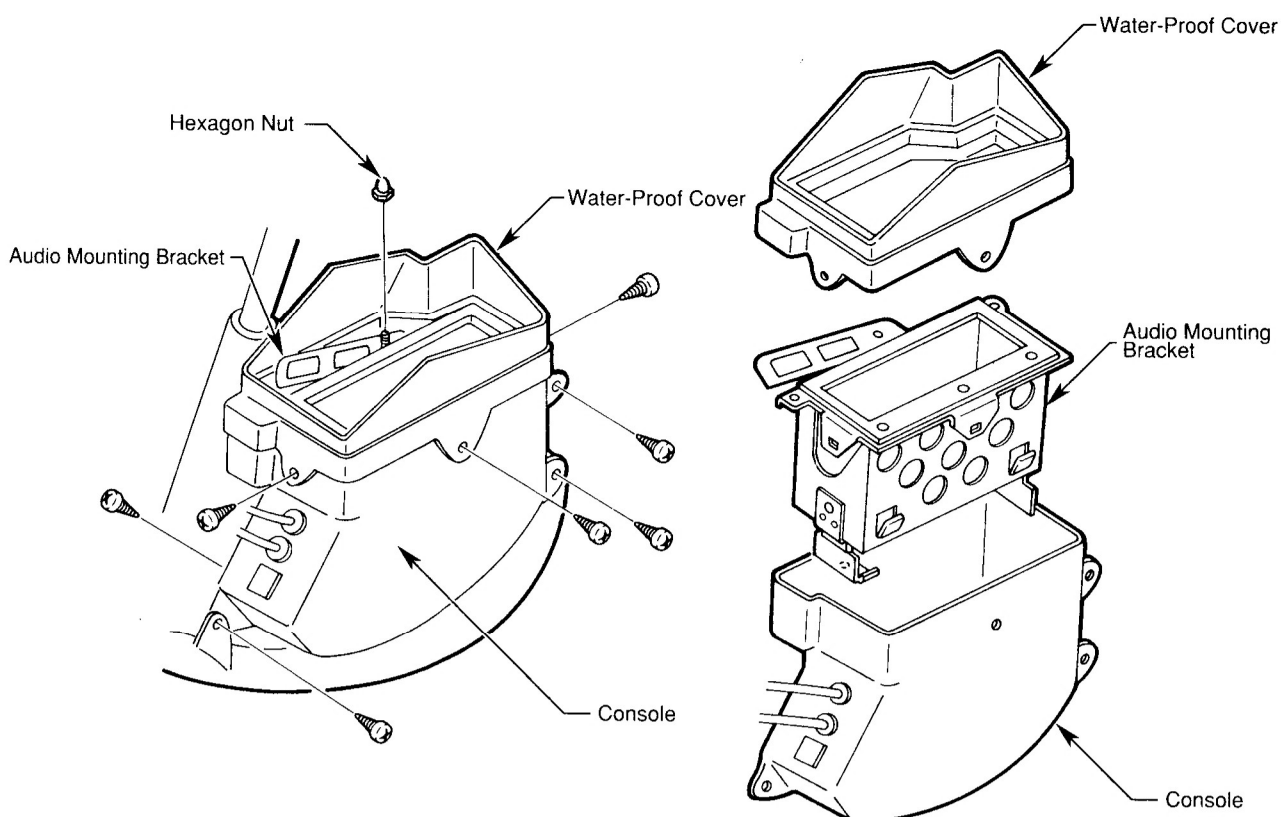
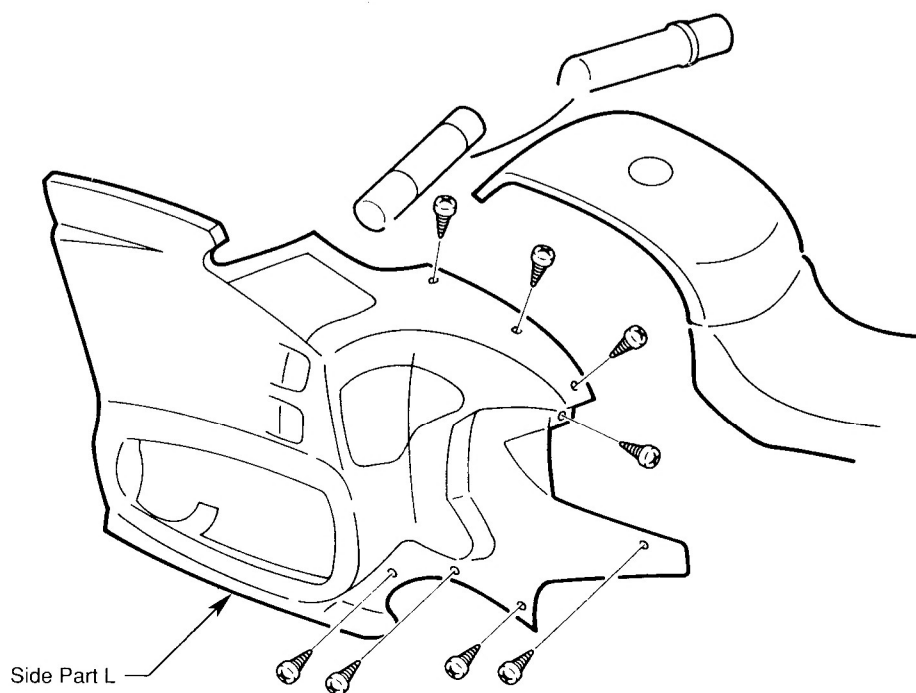

## ■ MOUNTING THE REMOTE CONTROL UNIT

<for models R100RT, K1100LT, and K100RT/LT>

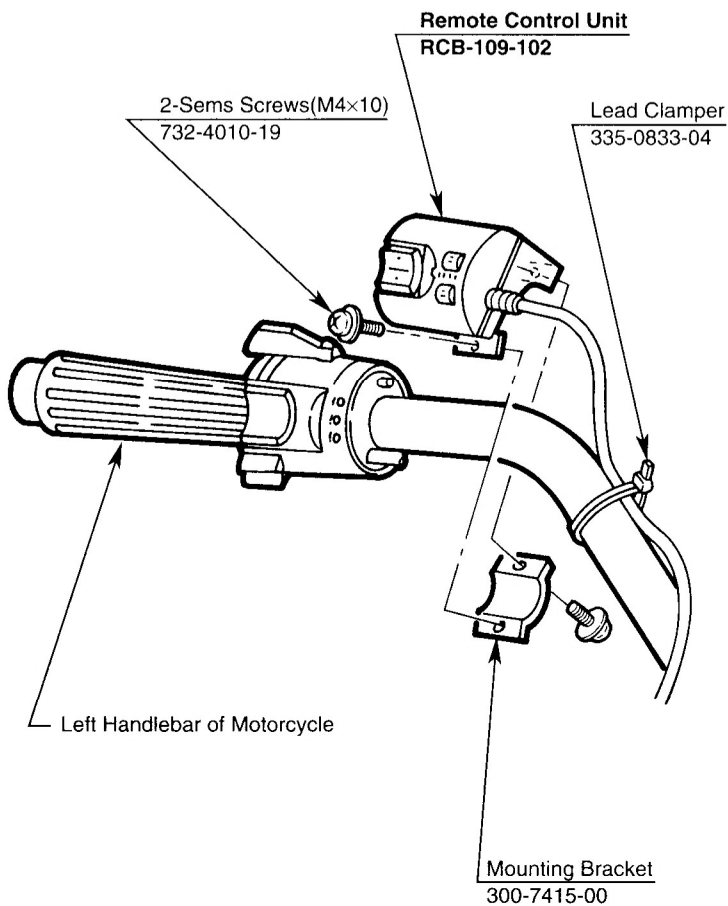

1. Fix the remote control unit to the place where it does not interfere with the left handlebar operation.

2. Secure the connection cord with the lead clamper (335-0833-04) so that it does not interfere with the left handlebar operation. (Check that the cord does not tense by turning the handlebar and does not interfere with the operation, and fix it.)

\* Bind the connection cord and other cords with the lead clamper (335-0833-04) at an appropriate place.

<for model R1100RT>

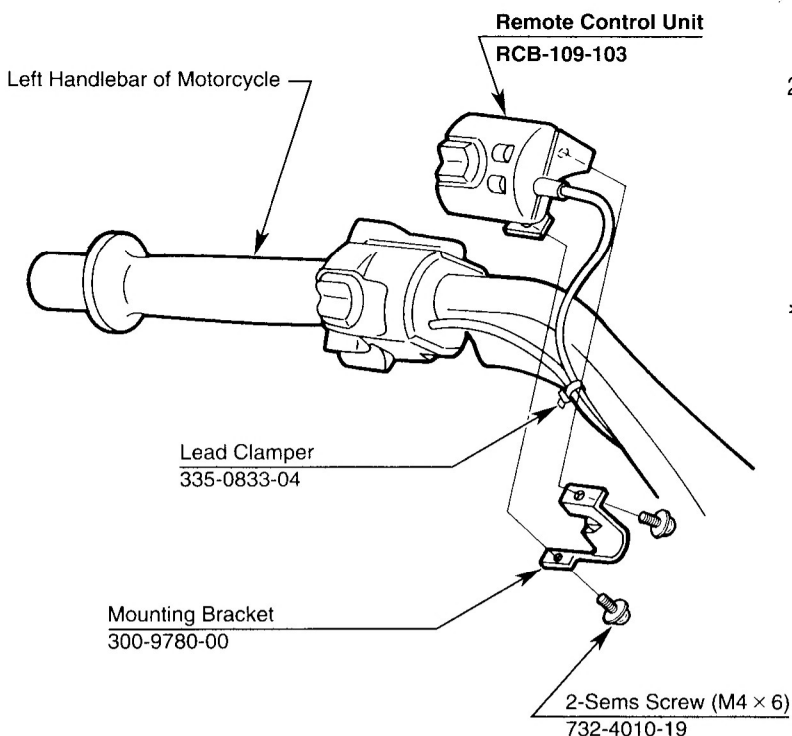

1. Fix the remote control unit to the place where it does not interfere with the left handlebar operation.

2. Secure the connection cord with the lead clamper (335-0833-04) so that it does not interfere with the left handlebar operation. (Check that the cord does not tense by turning the handlebar and does not interfere with the operation, and fix it.)

\* Bind the connection cord and other cords with the lead clamper (335-0833-04) at an appropriate place.

## ■ WIRING THE REMOTE CONTROL CONNECTION CORD

<for models R100RT, K1100LT, and K100RT/LT>

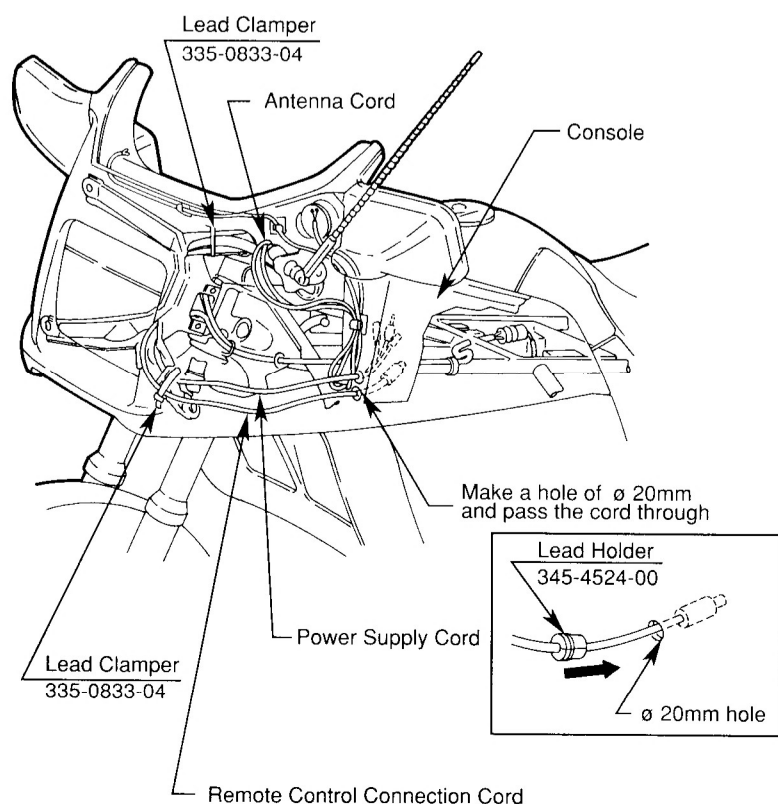

1. Make a hole of  $\phi$  20mm near the hole for the power supply cord and the antenna cord to pass the remote control connection cord through, and pass the remote control connection cord through the hole and then connect it to the cable from the main unit.
2. Insert the remote control connection cord into the lead holder (345-4524-00) and mount it on the hole in the console (the hole diameter for the lead holder is 20mm).

<for model R1100RT>

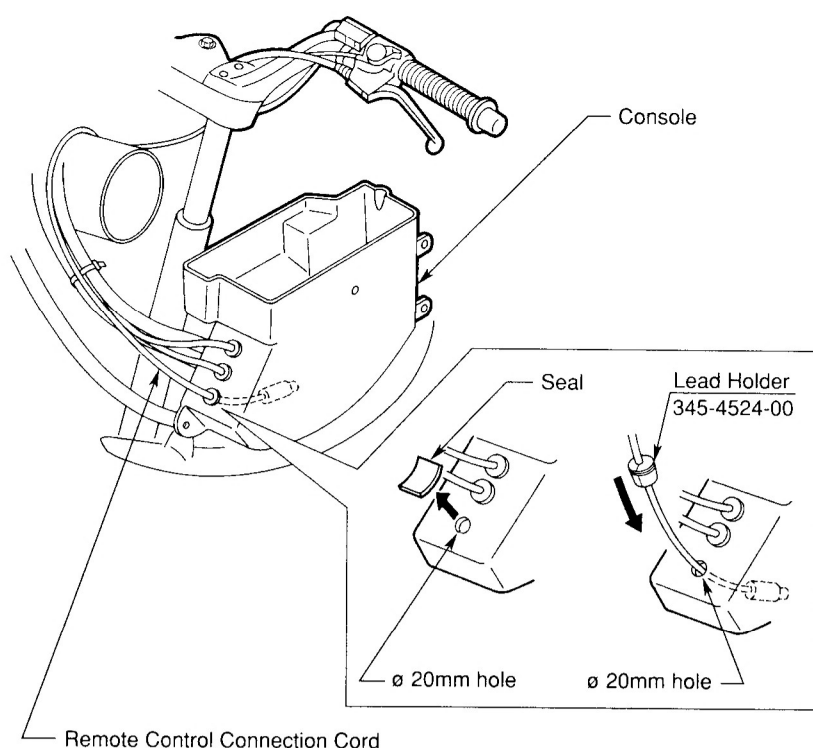

1. Peel off the seal on the console covering a hole.
2. Insert the remote control connection cord into the lead holder (345-4524-00) and mount it on the hole of the console (the hole diameter for the cord holder is 20mm).
3. Connect the remote control connection cord to the cable from the main unit.

## ■ MOUNTING THE SUDE BRACKET

<for models R100RT, K1100LT, and K100RT/LT>

1. Remove the main unit from the slide bracket (300-7346-03).  
Insert the removal tools into the holes in the main unit until they are locked in position, then pull the removal tools toward you to remove the main unit.
2. Insert the slide bracket (300-7346-03) into the audio mounting bracket, bend Tabs on the slide bracket and secure it with the two Sems screws (M4 × 6, 732-4006-11) to prevent it from looseness.

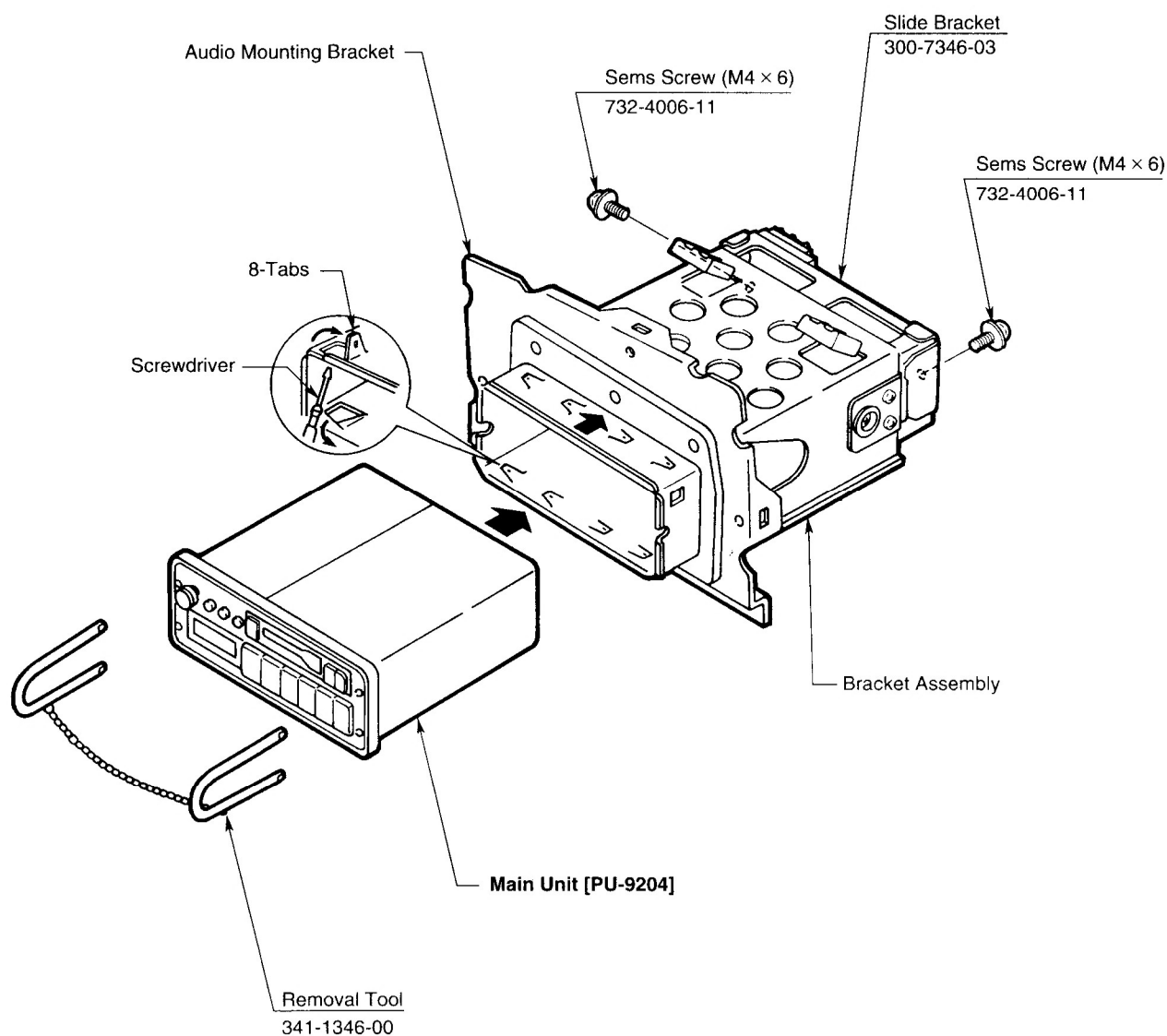

## ■ MOUNTING THE SLIDE BRACKET

<for model R1100RT>

1. Remove the main unit from the slide bracket (300-7346-03).  
Insert the removal tools into the holes in the main unit until they are locked in position, then pull the removal tools toward you to remove the main unit.
  2. First, insert the main unit into the slide bracket (300-7346-03).
- \* Unless the main unit is inserted into the slide bracket, it cannot be mounted on the audio mounting bracket.
3. Insert the slide bracket with the main unit into the audio mounting bracket (300-7346-03) and fix it with two Sems screws (M4 × 6, 732-4006-11).
  4. Carry out the above assembling procedure with the main unit mounted in the slide bracket.

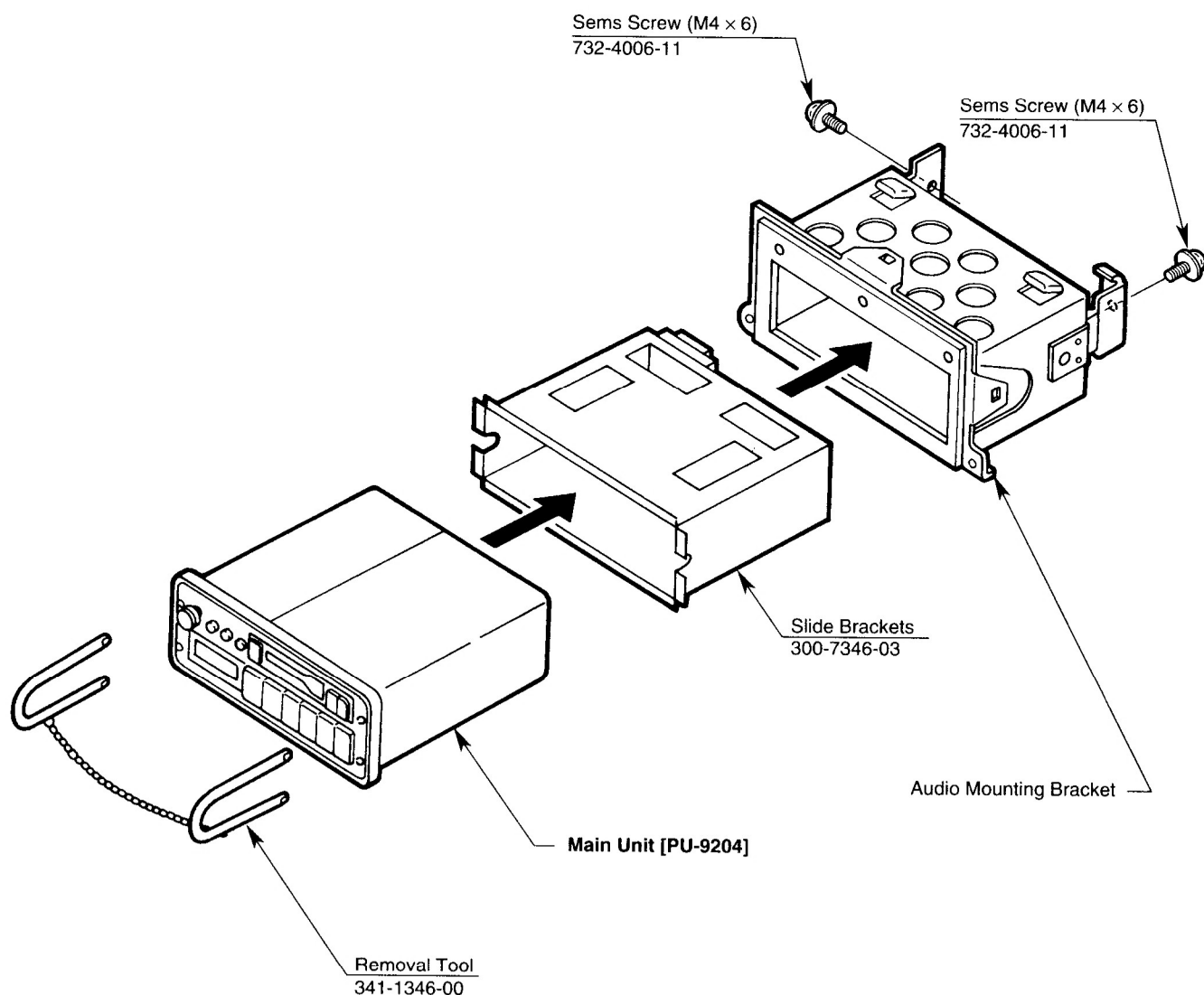

1. Connect the antenna, remote control cable and wire harness connectors to the slide bracket carrier frame assembly. Note: Locate remote controller cable alongside radio bracket and carefully guide the carrier frame assembly into place and install radio into the slide bracket.

Test all features and functions of the radio.

To operate radio, the security code must be entered.

**To enter code:**

- Turn the ignition key, park position.
- Turn on the radio.
- Enter the Electronic Security code by using the six station preset buttons (4 digit code).

After the last digit is entered, the unit will operate.

If you make a mistake when entering the security code press and hold the Band button, until the display clears. Then enter the correct code.

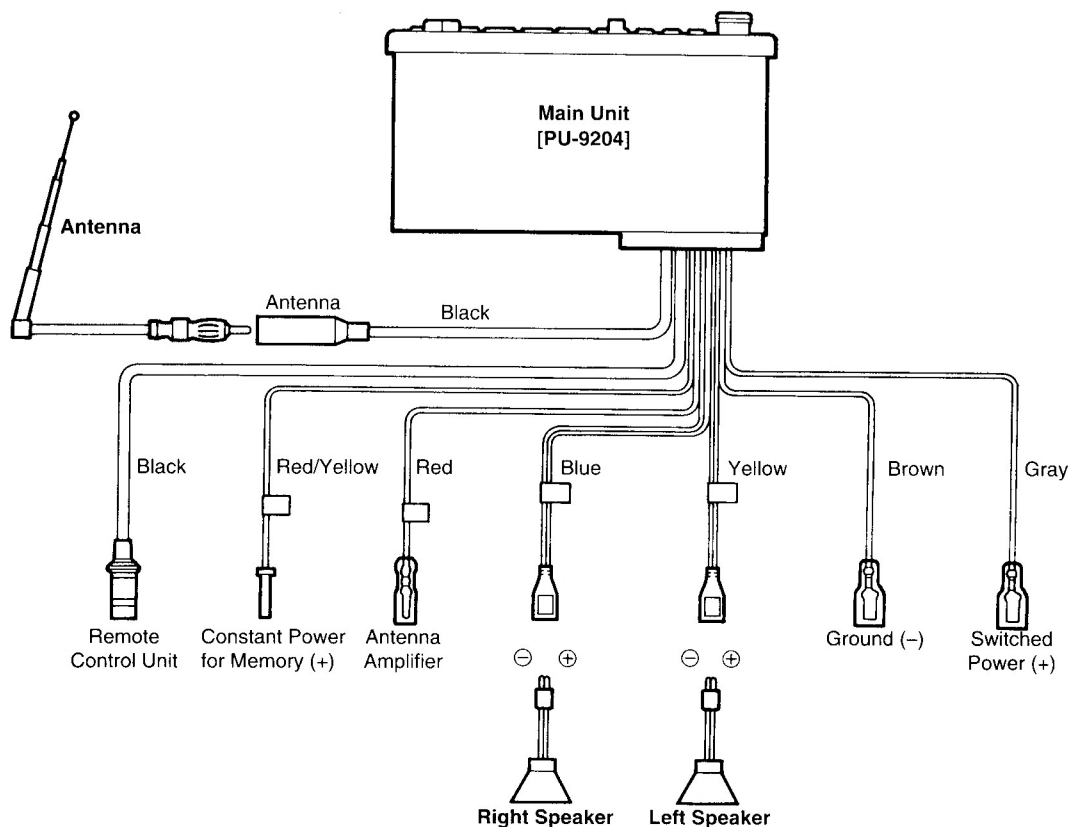

2. Place windscreen decal (Figure A) on inside of windscreen; do not place where it can obscure driver's vision. Left lower corner is preferred unless state or Local Laws prohibit placement on windshield area.
3. Place warning sticker (Figure B) on under side of radio compartment cover.



**Figure A**

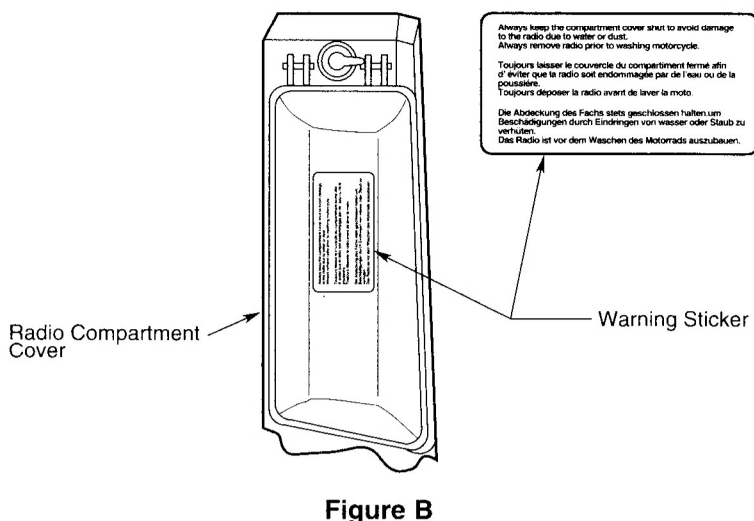

**Figure B**